

AJ4 - Analog Joystick

The AJ4 Joystick from DeltaTech Controls provides the reliability and long life required in demanding environmental conditions such as heavy duty industrial applications. Building on DTC's industry leading hall-effect joystick technology, the AJ4 controller combines flexibility with high mechanical strength. This strength and the unique sensing design make the joystick ideal for rigorous use in rugged, harsh environments offering best durability. The AJ4 Joystick is designed to accommodate standard and custom designed multifunction grips (MFG).



Main Features

- Contactless sensing – Hall effect technology
- Life greater than 6 million cycles
- 2 sensors per axis
- Integrated temperature compensation
- Environmentally sealed
- Potted electronics
- Standard or customized grips

Custom modifications

- Output characteristics
- Operating force
- Lever deflection angle
- Gate pattern
- Over travel and detent function
- Options for levels of redundancy
- Multifunction grips

Electrical Data

Variant

Supply Ratings:

- System Voltage 12V or 24V DC
- Voltage range 9V ... 36V DC
- Maximum current 75 mA at 24V dc

PWM Output	PW2	500 Hz \pm 80 Hz
CAN Bus Output	J19	SAE J1939
Other electrical Characteristics	EMI	100 V/m

Mechanical Data

Life > 6 million cycles

Operating temperature - 40°C to 85°C
Storage temperature - 40°C to 85°C

Operating torque	1	2,1 Nm
	2	2,6 Nm
	3	3 Nm

Horizontal maximum load (180mm from pivot point) 980 N (220 lbs)

Vertical load maximum 1110 N (250 lbs)

max. Torque (Z-axis) 25 Nm (18,5 ft lb)

Protection Level IP 67 above gate

Electronics Protection Fully potted

Gate options square

Lever deflection X/Y max : $\pm 21^\circ$ *

Center position tolerance $\pm 2^\circ$

Weight 860g

Housing Aluminum

Boot EPDM (black)

Cable Pigtail 600 mm without connector (24 AWG, 0,25 mm²)

* others available on request

AJ4 - Analog Joystick

Install dimensions for AJ4 – Joystick

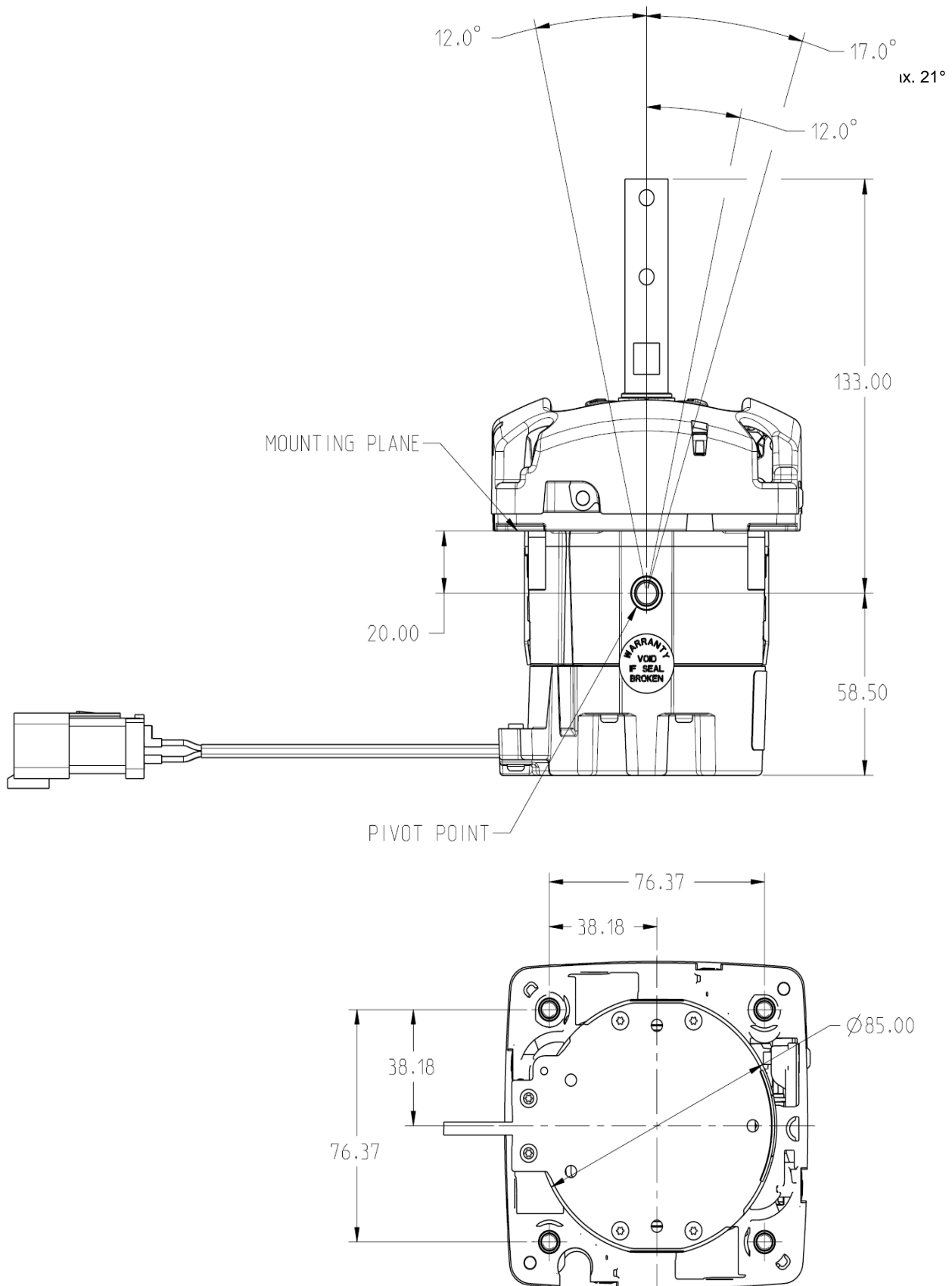

AJ4 - Analog Joystick



DeltaTech Controls – A CoActive Technologies Company - worldwide Facilities

With sales offices and manufacturing facilities located worldwide, please visit our website at www.deltatechcontrols.com for a complete listing and to find the office nearest to you.

France

2 Boulevard Michaël Faraday
Arlington Square, Bâtiment B
Serris – F 77716 Marne-La Vallée Cedex 4
France
phone: + 33 160 24 51 51
fax: + 33 3 84 69 08 97
Mail: sales.dtc.europe@coactive-tech.com

Germany

Holzhauser Strasse 26-32
D-13509 Berlin
Germany
phone: + 49 30 43 999 0
fax: + 49 30 43 999 203
Mail: sales.dtc.europe@coactive-tech.com

Hong Kong

Office:1007-8
10/F, Harcourt House
39 Gloucester Road
Wanchai, Hong Kong
phone: + 852 3713 5288
fax: + 852 2751 9926
Mail: sales.dtc.asia@coactive-tech.com

Tokyo

9F, Ariake Frontier Building B
3-1-25 Ariake, Koto-ku, Tokyo 135-0063
Japan
phone: +81 3 5530 9365
fax: +81 3 5530 8737
Mail: sales.dtc.japan@coactive-tech.com

USA

5288 Valley Industrial Blvd. S
Shakopee, MN 55379
USA
phone: + 1 952 403 7400
fax: + 1 952 233 9707
Mail: sales.dtc.americas@coactive-tech.com



No information and data contained in this publication shall be construed to create any liability on the part of DeltaTech Controls GmbH. Any new issue of this publication shall automatically invalidate and supersede any and all previous issues. Dimensions are subject to change without prior notice.

All Copyrights belong to DeltaTech Controls GmbH and CoActive Technologies.
All other trademarks or registered trademarks are property of their respective owners.
All data subject to change without notice. ©2009